



Image Elements

The Image element allows you to add an image to your survey.

Check out our new robot models!



Model: Pink



Model: Big Guy



Model: Poindexter

8. What features are important to you when purchasing a new robot? (Select all that apply)

Battery Life

Ease of Use

When To Use It

Use Images for your respondents to reference in the survey. For example, ask respondents to compare one product or logo to another. Image elements do not collect data.

Setup

To add an Image element:

1. Click **Add New Text/Media** and select **Image**.
2. Enter an image title in the **Text or Instructions** field. You will have the option to display this in the next step.
3. Go to the **Options** tab and click the image placeholder to select an image to display.

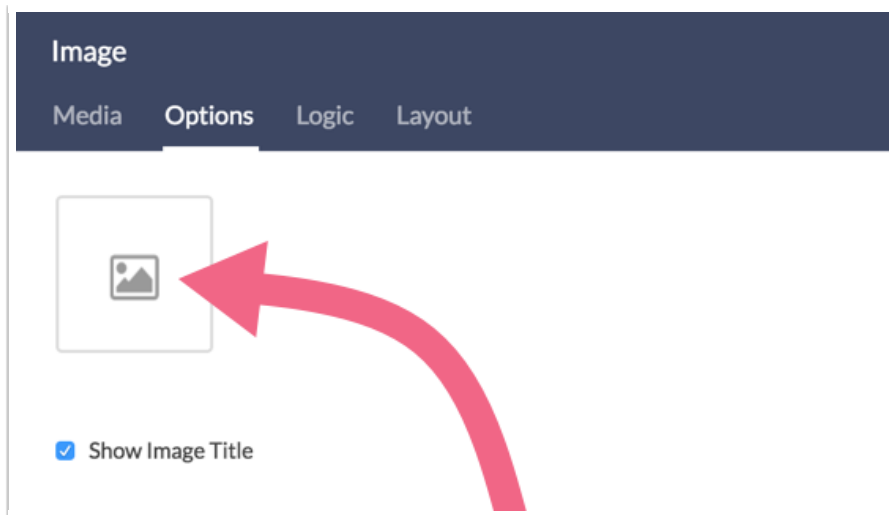

4. From here you can **a)** select an image [from your library](#), **b)** upload an image or **c)** enter an image URL for an image that his hosted elsewhere on the web. **Click Insert Image** when you are finished.

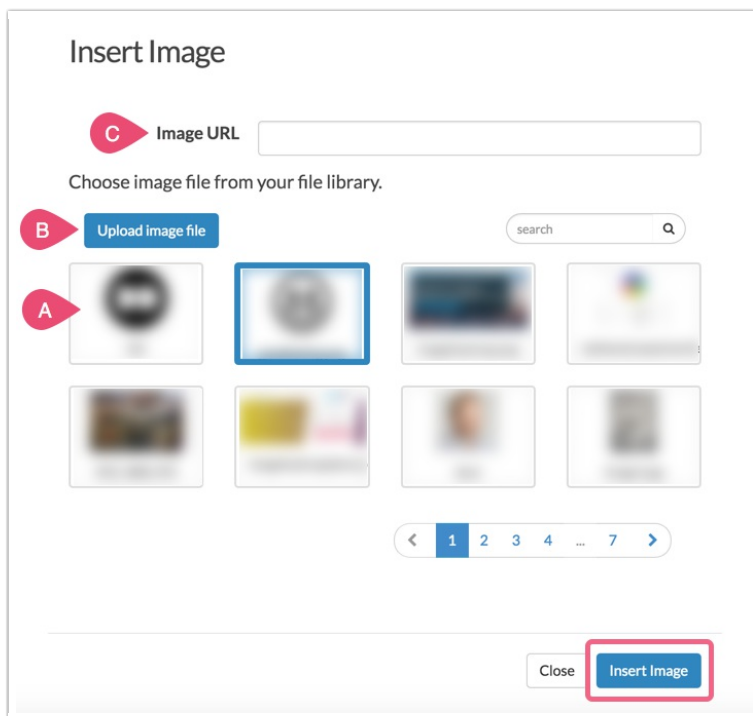

5. If you prefer to display the image with no title scroll down on the **Options** tab and deselect **Show Image Title**.

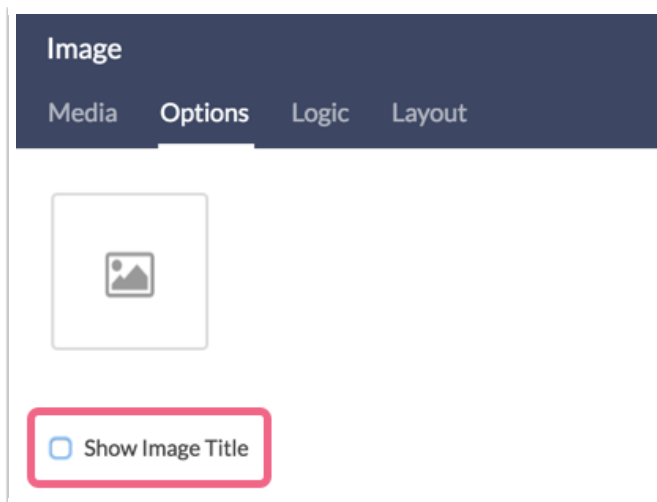

Best Practice Tip: Recommended Image Size

When uploading images to the file library you have the option to scale your image using pixel width or a percent. There are also various tools online to resize images e.g. <http://www.picsize.com/>. It is important to note that resizing images may negatively affect the quality of the image.

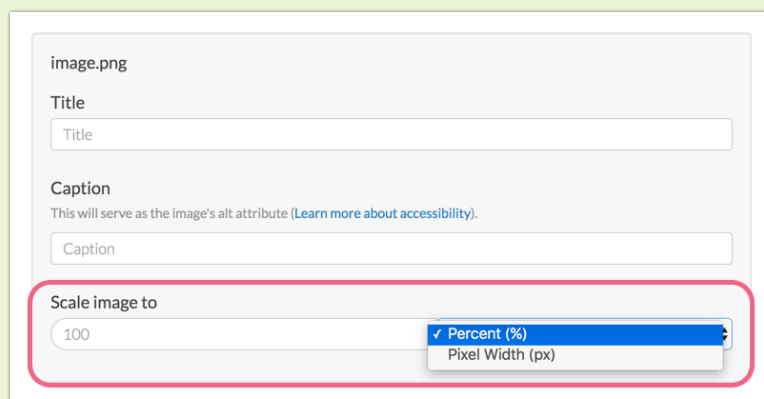

A Note about Image Elements and the One-at-a-time Survey Interaction

Image elements are their own elements on the page. This means that, depending on the survey interaction you choose, the Image element might display by itself.

For example, if you choose the one-at-a-time interaction, the image element displays by itself and the survey respondents must click the right arrow to proceed. This might be confusing to some respondents. If you are using image elements we recommend avoiding the [one-at-a-time interaction](#) or adding some instructions for how to proceed.